

MEG

MATERIAL EXTERIOR GRADE



MEG

ABET LAMINATI

Unlimited selection



Large range  
of decors available



Thicknesses from  
2, 3, 4, 6, 8, 10,  
12, 14, 16, 18 mm



Digital Print

PERFECT FOR



Façades



Balconies



Sunscreens



Street Furniture



Outdoor Signage

MEG STANDARD

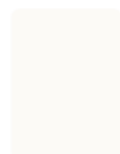

819 Bianco MEG



406 Bianco Primavera



405 Bianco Porcellana



1813 Magnolia

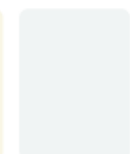

854 Silver Blu



414 Sabbia



475 Grigio Perla



416 Beige

MEG COLOURS



413 Beige Ardenna



869 Grigio Alpaca



1816 Sahara Beige



1801 Giallo Ocra



842 Verde Sub



1853 Muschio



812 Rosa Viola



893 Terra d'Ombra



837 Sarmiento



1810 Grigio Autunno



894 Viola Fumo



898 Bruno Fiandra



1870 Choclat



1820 Grigio Cosmico



1831 Grigio Fango



480 Grigio Piombo



871 Grigio Scuro



879 Grigio Grafite



421 Nero



487 Azzurro Polvere



1860 Samoa



847 Azzurro

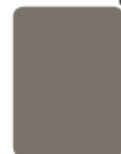

868 Grigio Medio



867 Grigio Cielo



1886 Giallo MEG



1812 Giallo Polenta



891 Scotch Brown



823 Rosso Tango



1885 Rosso MEG



832 Rosso Lord



1824 Blu Amorgos



850 Blu Rada



450 Verde Lauro



440 Verde Biliardo



499 Blu California



838 Blu Primario



851 Blu Cobalto



1804 Blu Tenebre



1861 Blu Notte



859 Blu Faenza



852 Blu Blu



498 Viola Giglio



1883 Melanzana

## MEG WOOD



## MEG METAL



713 MEG Metal

## MEG CONCRETE



545 Vulcano



## RAINSCREENS



Protects  
from rain  
and allows  
the ventilation



Resistant  
to natural  
weathering



Antistatic,  
good fire  
behavior



Easy to work  
and clean,  
eco-sustainable

In the early 50s the Building Research Station in UK showed the advantages of having a ventilated cavity in front of the building wall.

Alcoa Building (1951 | 1953 | PITTSBURGH | PENNSYLVANIA)

## VENTILATE FACADE | BENEFITS

ABET LAMINATI

Unlimited selection

The building wall is protected from the hot radiation in summer

The chimney effect generates ventilation that make the temperature decrease

The air cavity is a thermal intermediate between the internal and external sides

The panels protect the walls from the bad weather conditions

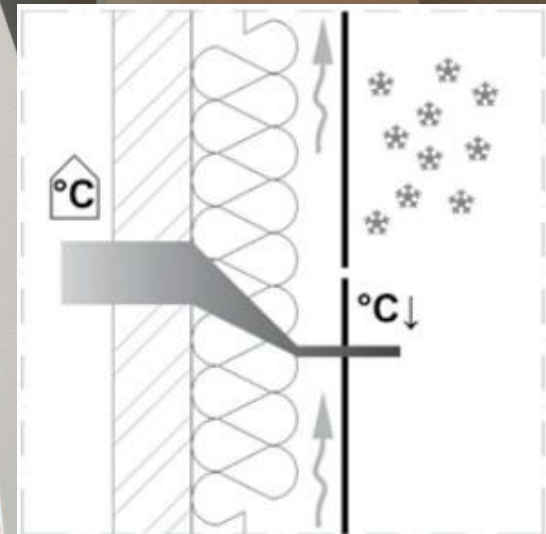
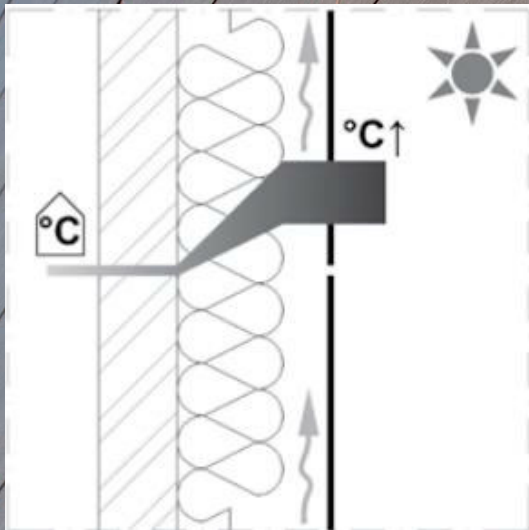



## MEG FIXING SYSTEMS | Visible mechanical fixing on an aluminium backing structure

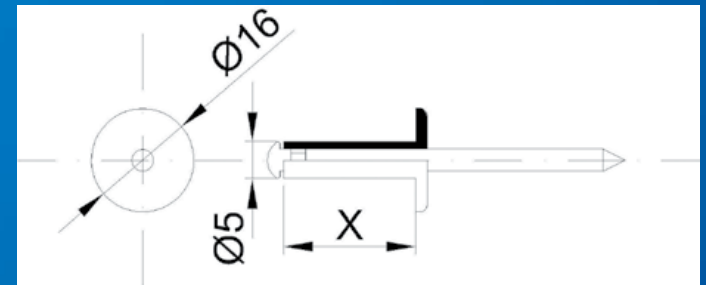
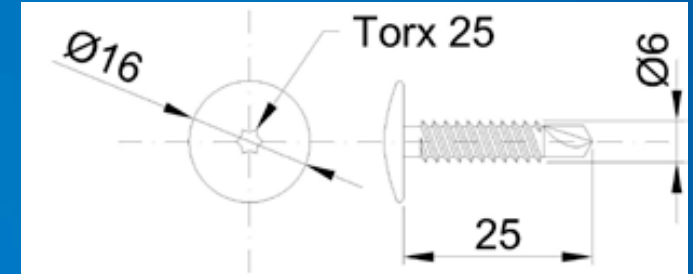



MEG FIXING SYSTEMS | Invisible fixing with overlapping panel strips  
(weatherboarding or lap siding)

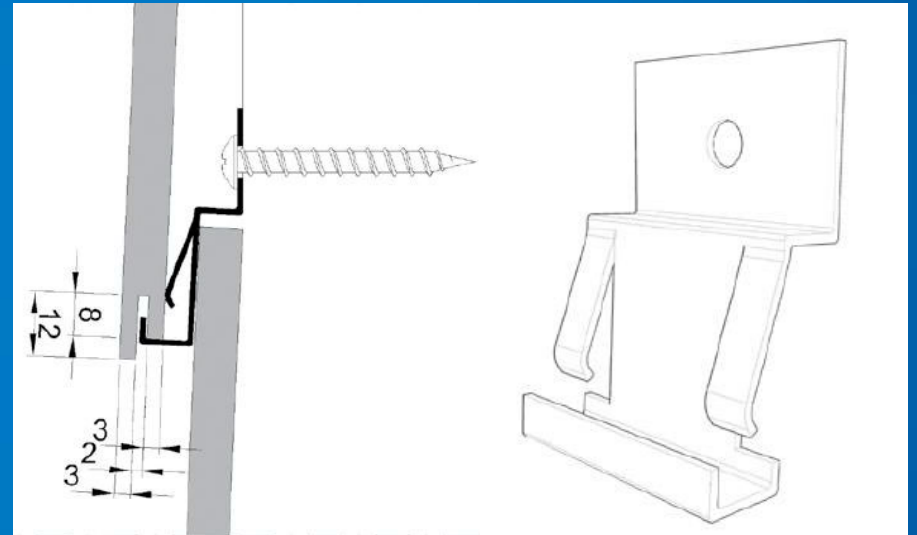

MEG FIXING SYSTEMS | Invisible fixing with profiled edged panels in horizontal running aluminium hook profile

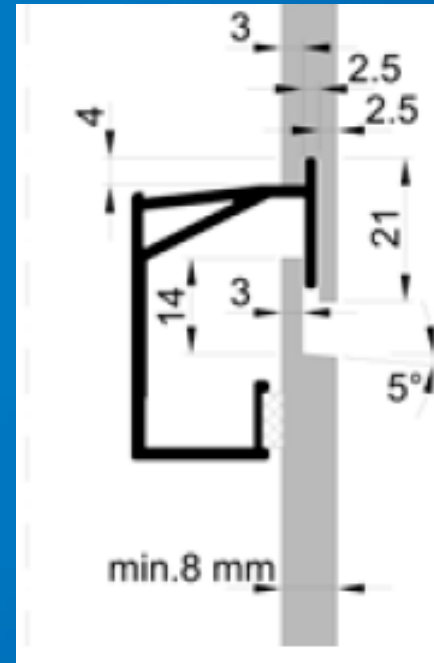
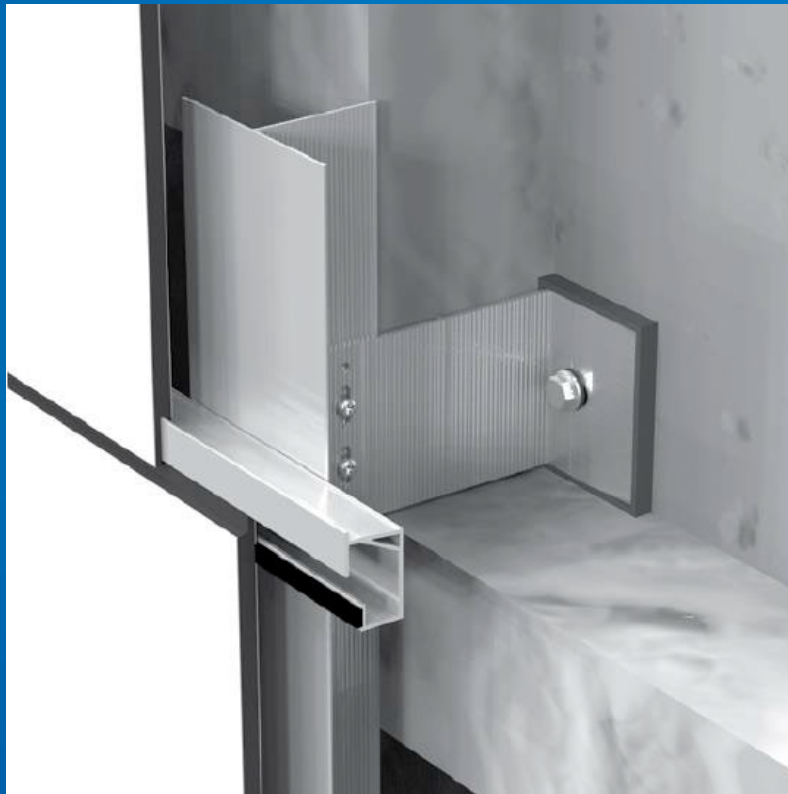

MEG FIXING SYSTEMS | Invisible fixing with profiled edged panels in  
horizontal running aluminium hook profile

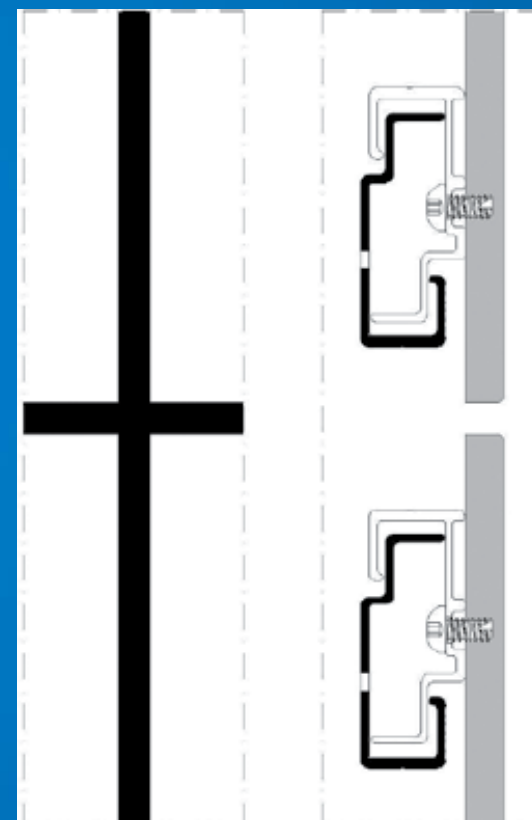





- Dynamic wind strenght
- Distance from MEG panels
- Calculate panel expansion with fix and movable fixing
- Air cavity behind the panels
- Measure the size of the panels for the layout of your facades
- Calculate the isolation materials tickness
- Vertical aluminium sub-structure dilatation.
- Anchoring in the proper way the aluminium or wood structure to the existing building

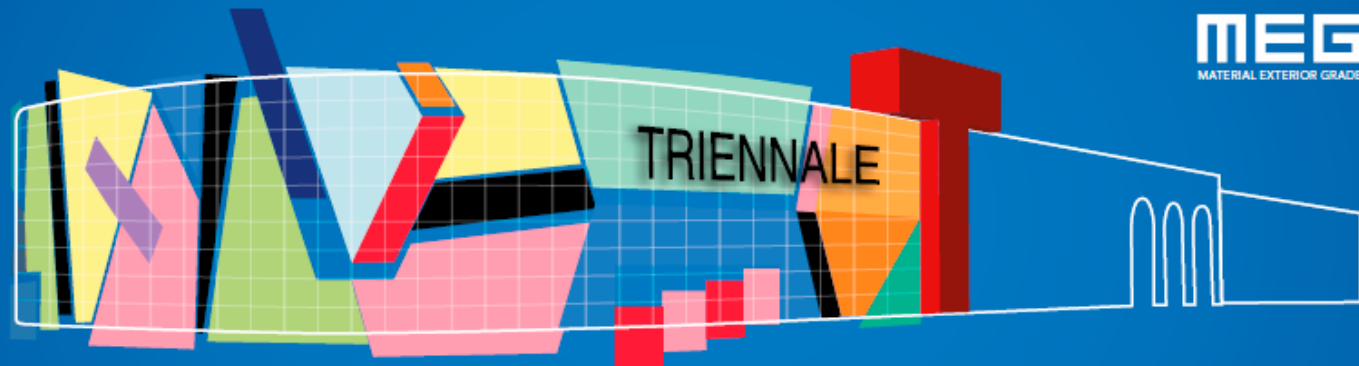

The «FIXED POINT» must be placed in the centre of every MEG panels in order to not allow further changes of position.

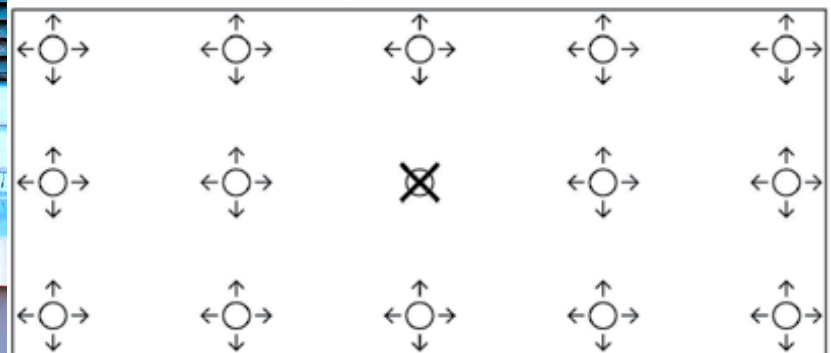
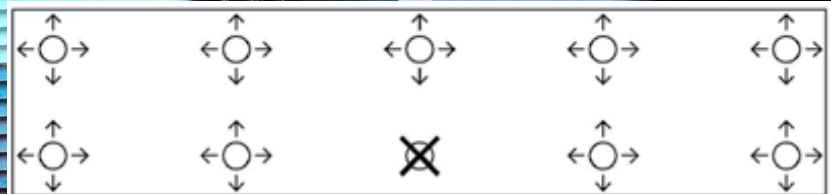

Rock Wool

Glass Wool

Polystyrene extruded

Polystyrene extruded with graphite

Structural polyurethane

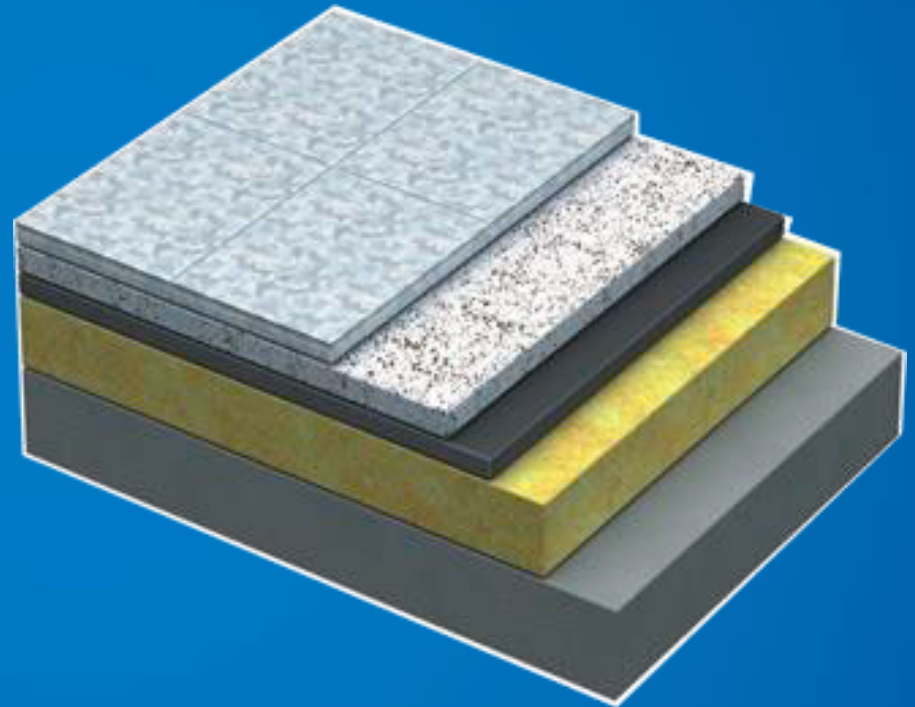



MEG | Casa O | 2015 | CAGLIARI | ITALY

ABET LAMINATI

Unlimited selection





MEG | Casa O | 2015 | CAGLIARI | ITALY

ABET LAMINATI

Unlimited selection





MEG | TRAIN STATION | 2012 | KOKSIJDE | BELGIO

ABET LAMINATI

Unlimited selection



MEG | TRAIN STATION | 2012 | KOKSIJDE | BELGIUM

ABET LAMINATI



Unlimited selection





MEG | TRAIN STATION | 2012 | KOKSIJDE | BELGIUM

ABET LAMINATI



Unlimited selection









MEG | Triennale | 2009 | INCHEON | SOUTH KOREA

ABET LAMINATI

Unlimited selection



MEG | Tuincentrum Pelckmans | 2010 | TURNHOUT | BELGIUM

ABET LAMINATI

Unlimited selection





MEG | Tuincentrum Pelckmans | 2010 | TURNHOUT | BELGIUM

ABET LAMINATI



Unlimited selection

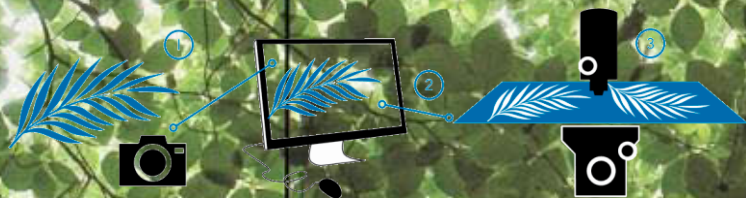



MEG | “Nest” Casa Clima | 2011 | CERVIA | ITALY

ABET LAMINATI



Unlimited selection

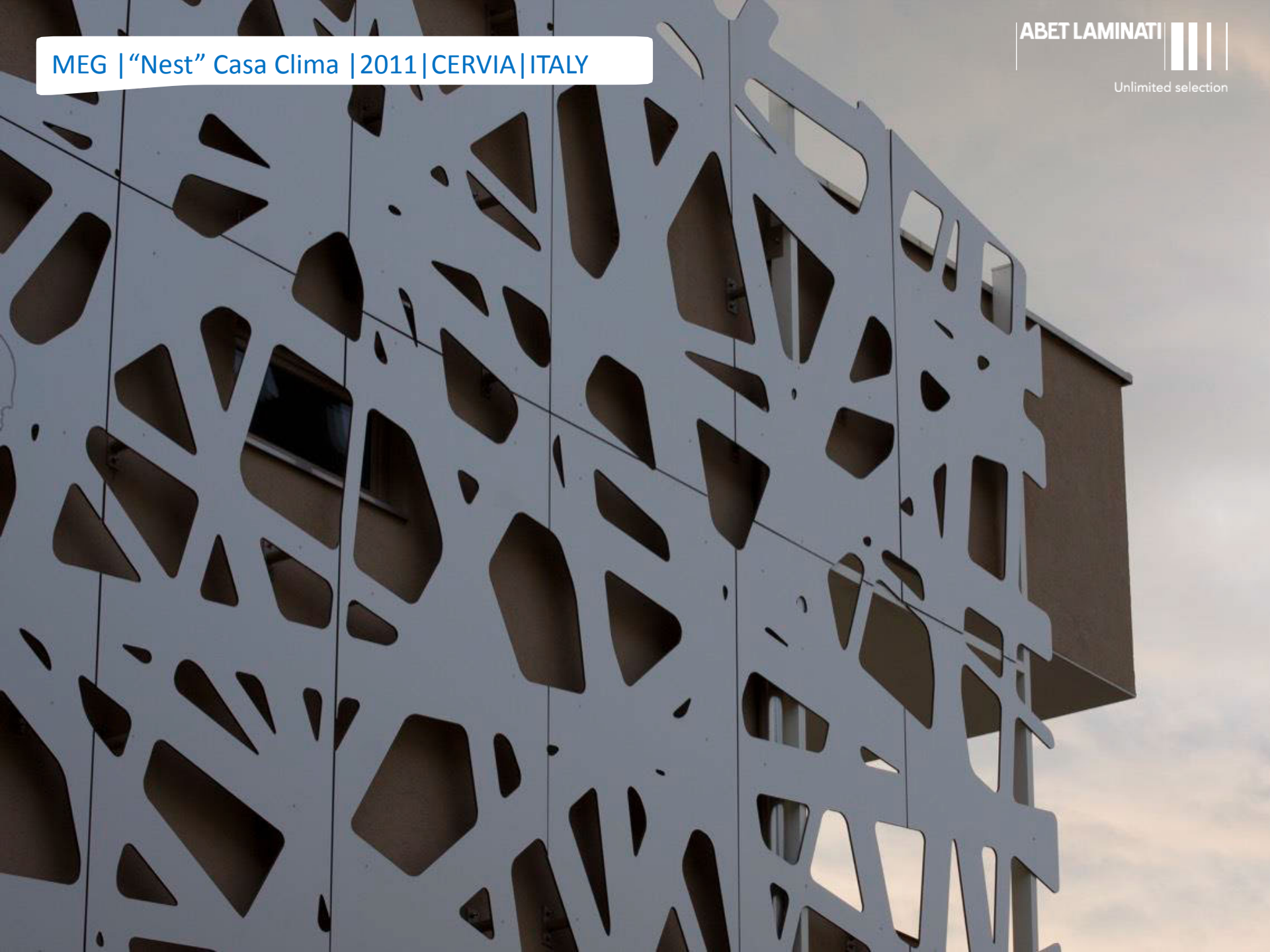

MEG | “Nest” Casa Clima | 2011 | CERVIA | ITALY

ABET LAMINATI



Unlimited selection





MEG | RESIDENCE TASSIN | 2014 | FRANCE

ABET LAMINATI



Unlimited selection

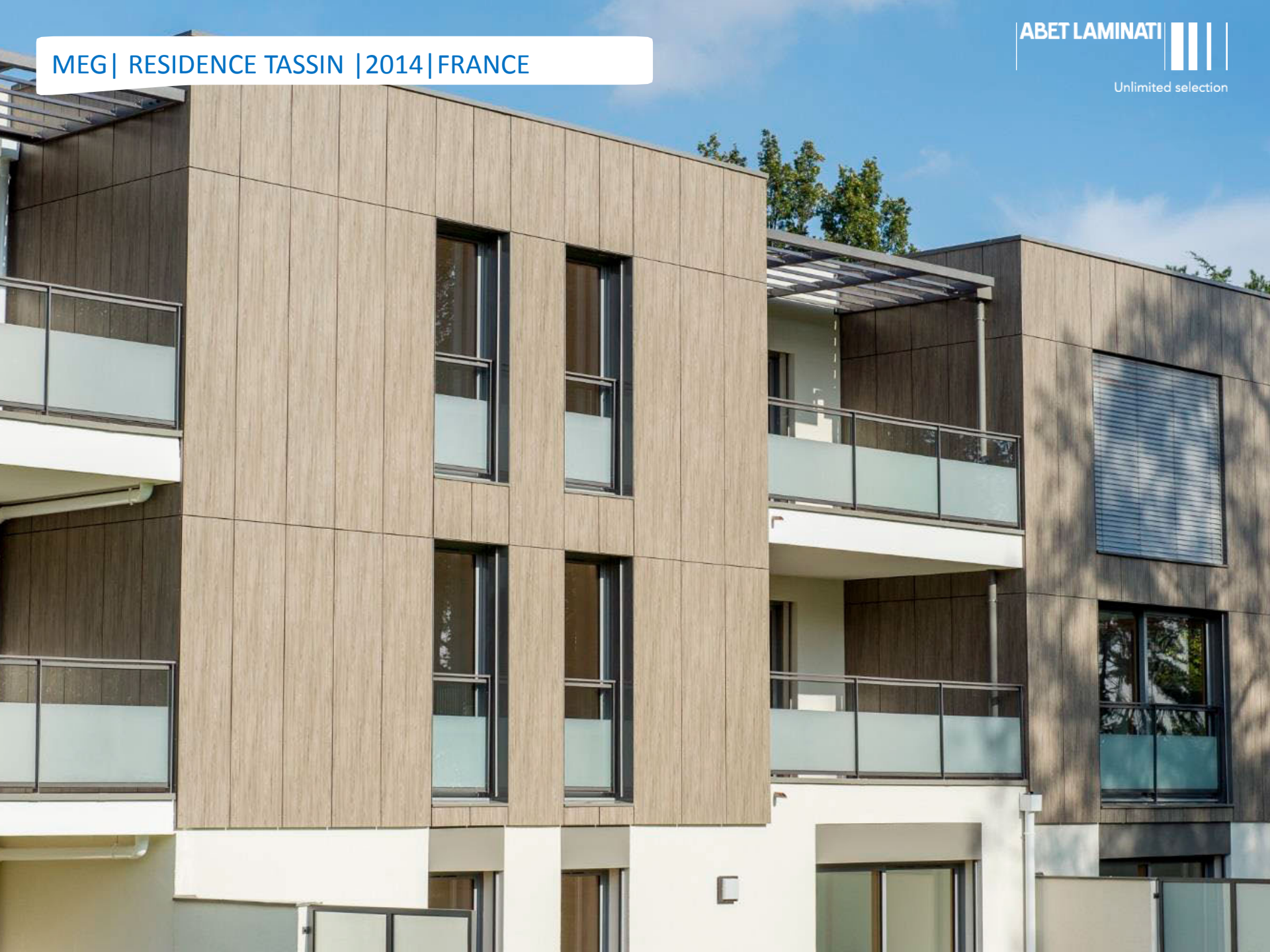

MEG | RESIDENCE TASSIN | 2014 | FRANCE

ABET LAMINATI



Unlimited selection





MEG | SCHOOL | 2013 | DANZICA | POLAND





MEG | ABET PARK | 2013 | CHAMBERY | FRANCE

ABET LAMINATI



Unlimited selection





MEG | MUSEO ABET LAMINATI | 2013 | BRA | ITALY

ABET LAMINATI

Unlimited selection

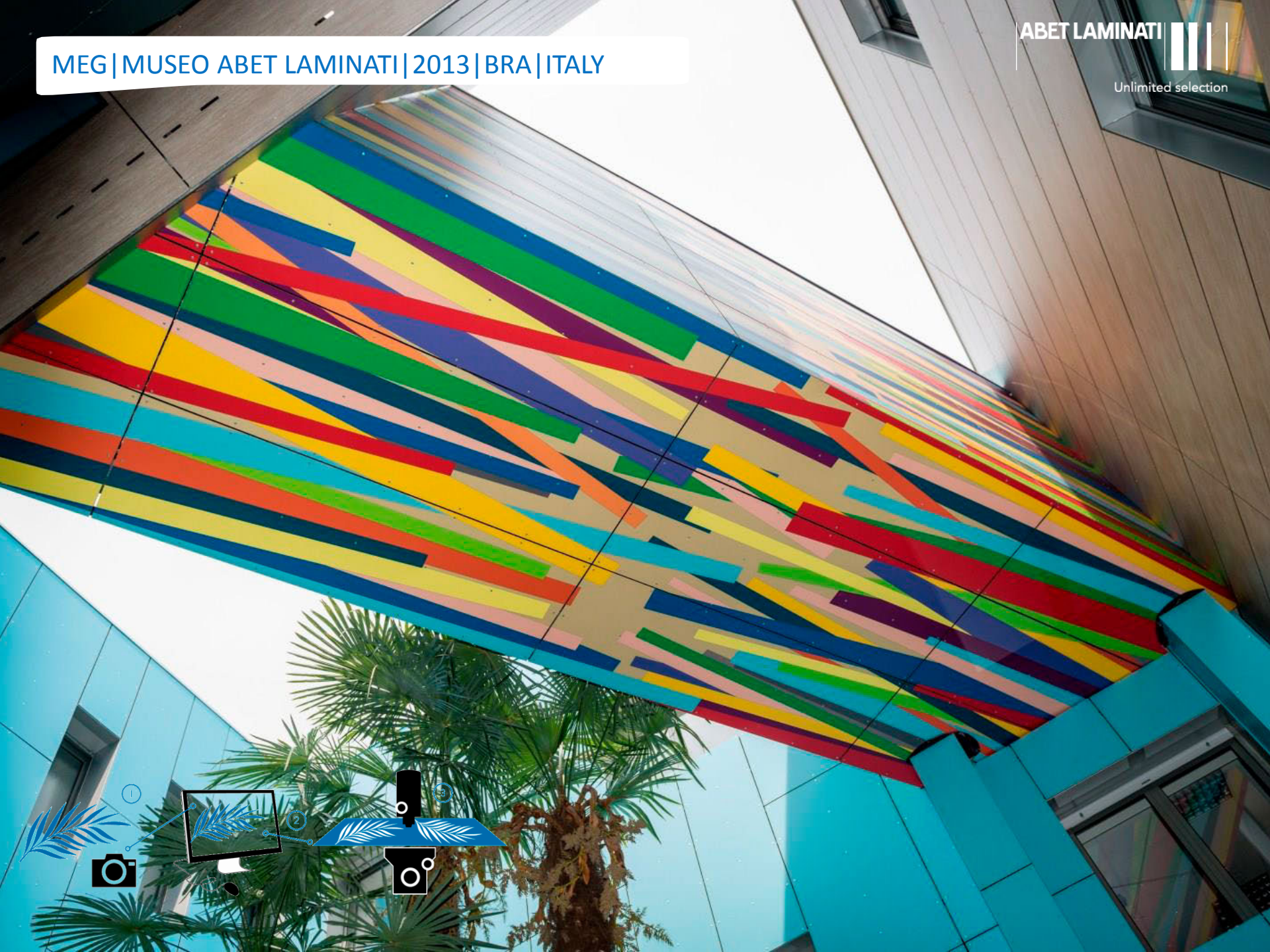

MEG | MUSEO ABET LAMINATI | 2013 | BRA | ITALY

ABET LAMINATI

Unlimited selection





MEG | BRABBEL SCHOOL | 2010 | BELGIUM

TABET LAMINATI

Unlimited

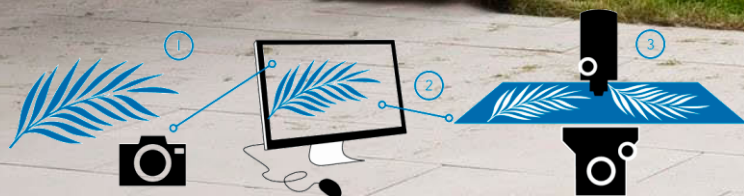
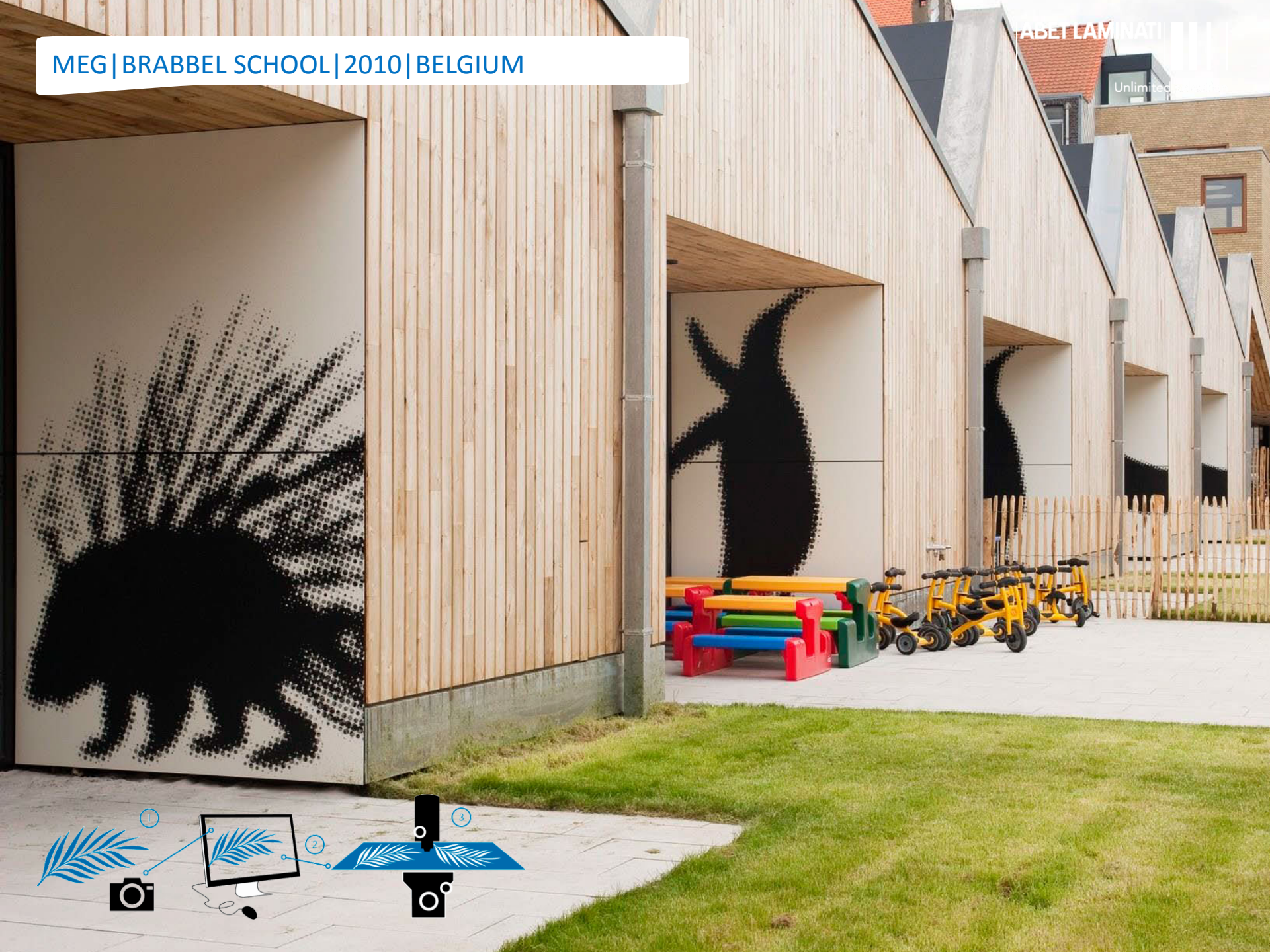





MEG | DE ZEVEN TORENTJES HOSPITAL | 2011 | BRUGES | BELGIUM

ABET LAMINATI

Unlimited selection





MEG | RESIDENTIAL BUILDING | 2014 | LEBANON

ABET LAMINATI



Unlimited selection

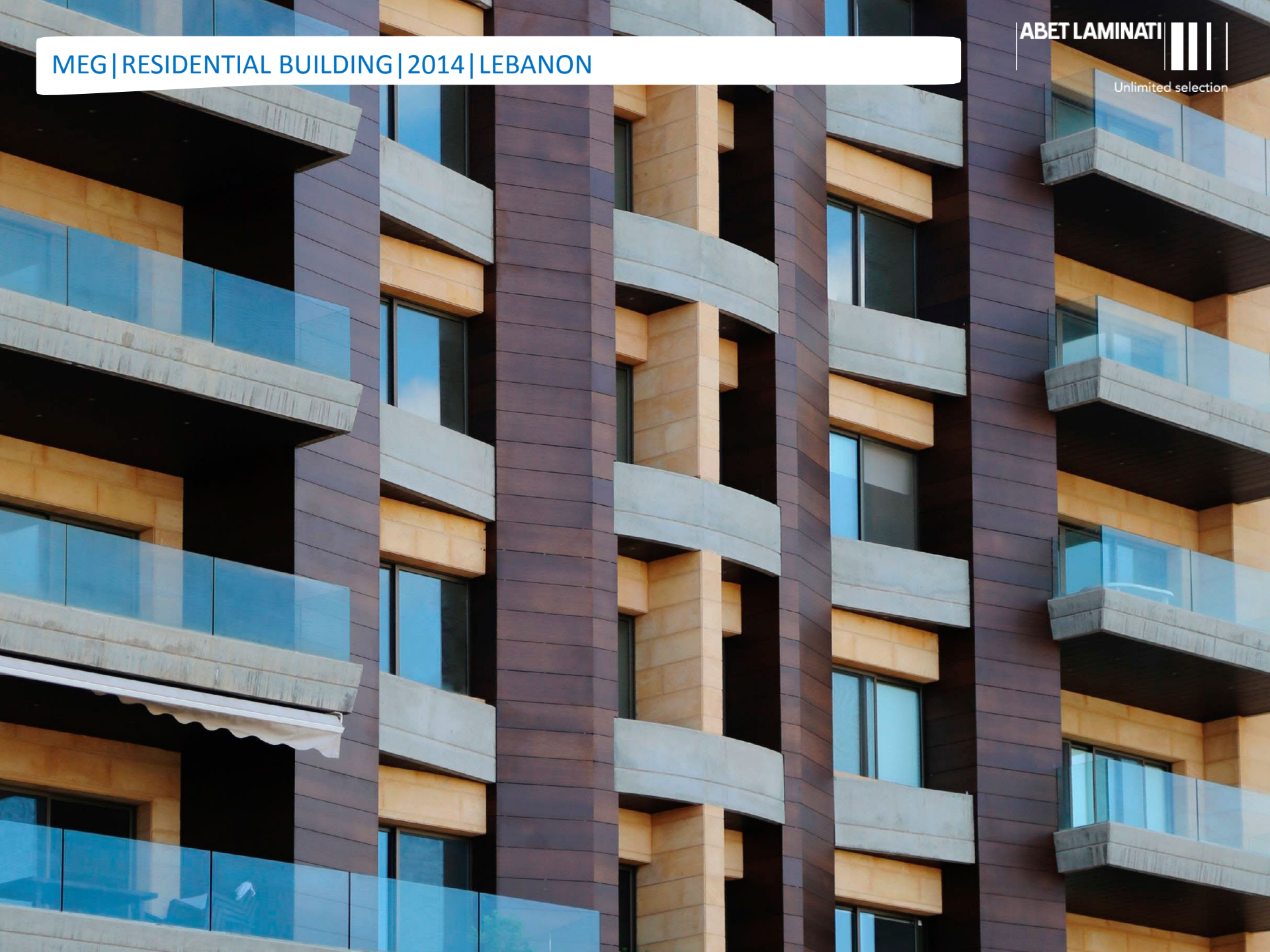















Thank you for your kind attention



Unlimited selection